

3-in-1 Zebra Scooter



VTech understands that a child's needs and abilities change as they grow and with that in mind we develop our toys to teach and entertain at just the right level...

vtech Baby

Toys that will stimulate their interest in different textures, sounds and colours

I am...

...responding to colours, sounds and textures

...understanding cause and effect

...learning to touch, reach, grasp, sit-up, crawl and toddle

Birth-36 months



Pre-School

Interactive toys to develop their imagination and encourage language development

I want...

...to get ready for school by starting to learn the alphabet and counting

...my learning to be as fun, easy and exciting as can be

...to show my creativity with drawing and music so my whole brain develops

3-6 years



Electronic Learning Computers

Cool, aspirational and inspiring computers for curriculum related learning

I need...

...challenging activities that can keep pace with my growing mind

...intelligent technology that adapts to my level of learning

...National Curriculum based content to support what I'm learning at school

4-10 years



To learn more about this and other VTech® products, visit www.vtechuk.com

INTRODUCTION

Thank you for purchasing the **VTech® 3-in-1 Zebra Scooter!**

The **VTech® 3-in-1 Zebra Scooter** converts easily from push walker to ride-on to scooter. Children can discover their wild side as they move with the zebra and explore with the scooter's walkie-talkie, compass and torch. The zebra's mane features five light-up buttons that teach colours, animals and more. The scooter also features fun horn and smile buttons and a range of melodies, fun sounds and phrases.

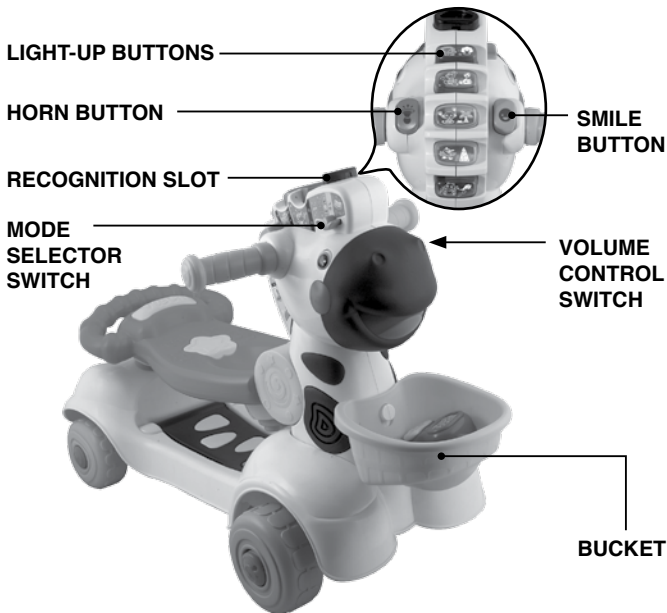

INCLUDED IN THIS PACKAGE



One zebra head with electronic parts



One handle/seat



One big screw



Two front wheels

One user's manual

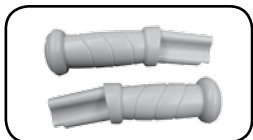

Two handles



One zebra body and two longer screws



Three play pieces and one bucket



One axle, one wheel fastener and one wheel cover with two shorter screws

WARNING: All packing materials, such as tape, plastic sheets, wire ties and tags are not part of this toy, and should be discarded for your child's safety.

NOTE: Please keep this instruction manual as it contains important information.

GETTING STARTED

BATTERY INSTALLATION

1. Make sure the unit is turned **OFF**.
2. Locate the battery cover on the side of the zebra's head. Use a screwdriver to loosen the screw.
3. Install 2 new 'AA' (AM-3/LR6) batteries following the diagram inside the battery box. (The use of new alkaline batteries is recommended for maximum performance.)
4. Replace the battery cover and tighten the screw to secure.

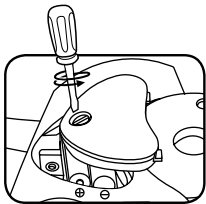

BATTERY NOTICE

- The use of new alkaline batteries is recommended for maximum performance.
- Non-rechargeable batteries are not to be recharged.
- Rechargeable batteries are to be removed from the toy before being charged (if removable).
- Rechargeable batteries are only to be charged under adult supervision (if removable).
- Different types of batteries or new and used batteries are not to be mixed.
- Only batteries of the same or equivalent type as recommended are to be used.
- Batteries are to be inserted with the correct polarity.
- Exhausted batteries are to be removed from the toy.

- The supply terminals are not to be short-circuited.
- The toy is not to be connected to more than the recommended number of power supplies.
- Do not dispose of batteries in fire.

WE DO NOT RECOMMEND THE USE OF RECHARGEABLE BATTERIES.

Help the environment by disposing of your product responsibly.

The wheelie bin symbols indicate the product and batteries must not be disposed of in the domestic waste as they contain substances which can be damaging to the environment and health. Please use designated collection points or recycling facilities when disposing of the item or batteries.

More information can be found on:

<http://www.recycle-more.co.uk>; www.recyclenow.com



ASSEMBLY INSTRUCTIONS

With the **VTech® 3-in-1 Zebra Scooter**, safety comes first. To ensure your child's safety, please only allow an adult to assemble this product.

1. To install the front wheels onto the zebra body, first put one wheel on the end of the axle, then thread the axle through the zebra body. Attach the other wheel to the end of the axle.

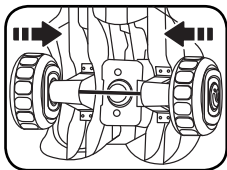

2. Attach the fastener to the end wheel, aligning the pin on the fastener with the hole in the axle. Push the pin down into the hole. Insert the wheel cover into the fastener, then tighten the two shorter screws with a screwdriver.

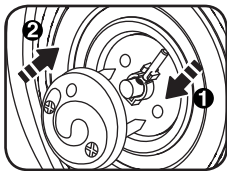

3. To attach the left and right handles to the zebra's head, insert them into the corresponding holes on the sides of the head. You will hear a loud 'click' sound. This indicates that the handles are securely fixed into the head.

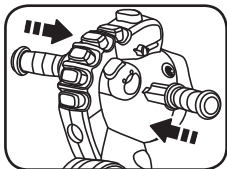

4. Attach the zebra's head to the body by inserting the head onto the body. You will hear it 'click' into place. Please ensure the head is attached securely to the body. Once the head has been attached, it cannot be removed again.

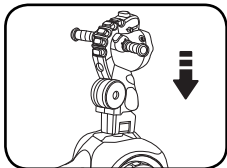

5. Turn the zebra over to tighten the two longer screws with a screwdriver. These are the screws that attach the neck to the body.

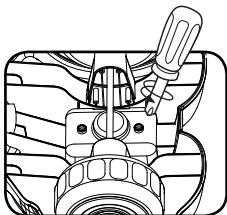

6. Insert the big screw under the seat. You will hear a loud 'click' sound.

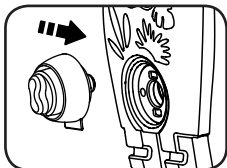

7. Attach the seat/handle into the yellow turning wheel on the zebra's neck. You will hear a loud 'click' sound. This indicates the seat is securely fixed to the neck.

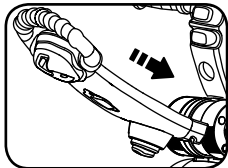

Once the **VTech® 3-in-1 Zebra Scooter** is assembled, it cannot be disassembled.

WARNING: This product is not strong enough to bear the weight of a child over 36 months.

Protective equipment should be worn.

Max weight 20kg.

1. Before riding the scooter, please make sure the handles are securely locked in place.
2. Please wear appropriate safety gear, including a helmet and knee pads, when riding the scooter.
3. Please ride the scooter on a smooth surface, such as a paved footpath. Do not ride the scooter on the road, or on gravel, sand or water.
4. Always ride the scooter during daylight. Avoid riding at night.
5. Always wear shoes when riding the scooter.
6. The scooter requires great skill and the need for adult supervision in order to avoid falls or collisions that could cause injury to the user or third parties.

CONVERTING THE 3-IN-1 ZEBRA SCOOTER

1. To change to ride-on position, put down the handle/seat, making sure it locks into place. Hang the bucket on the peg at the

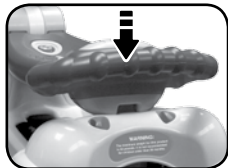

front of the neck.

2. To change to walker position, squeeze the two locks under the seat to release. Pull up the seat and the support on the scooter platform, propping the seat with the support. You will hear a loud 'click' sound to indicate the seat and support are locked into place.

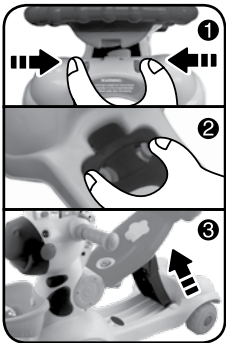

3. To disassemble the walker position, squeeze the two locks under the seat, then lower the support plate and the seat.

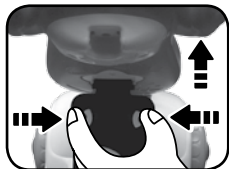

4. To change to scooter position, pull the seat up to meet the neck, and tighten the big screw under the seat.



5. To disassemble the scooter position, press and hold the black button on the side of

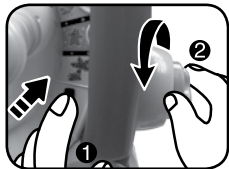

the neck, then unscrew the big screw under the seat.

PRODUCT FEATURES

1. MODE SELECTOR SWITCH

To turn the unit ON, slide the MODE SELECTOR SWITCH to the MUSIC MODE (🎵), FOLLOW THE LIGHTS MODE (💡), ANIMAL MODE (🐾) or EXPLORE & LEARN MODE (📖) position. To turn the unit OFF, slide the MODE SELECTOR SWITCH to the OFF (OFF) position.



2. VOLUME CONTROL SWITCH

To adjust the volume, slide the VOLUME CONTROL SWITCH located on the head to LOW VOLUME (🔊) or the HIGH VOLUME (🔊) position.



3. AUTOMATIC SHUT-OFF

To preserve battery life, the **VTech® 3-in-1 Zebra Scooter** will automatically power-down after approximately 20 seconds without input. The unit can be turned on again by pressing any button.

ACTIVITIES

1. MODE SELECTOR SWITCH

Turn the unit ON by sliding the MODE SELECTOR SWITCH to one of the modes.



MUSIC MODE 🎵

In this mode you will hear fun sounds, short tunes and melodies.

FOLLOW THE LIGHTS MODE 🏠

In this mode you will hear “Follow the lights, let’s go to the (scene)”
By pressing the corresponding button you will hear a rewarding sound. This mode includes animal names, sounds and habitats.

ANIMAL FRIENDS MODE 🐾

This mode introduces the characteristics of the 5 animals.

EXPLORE AND LEARN MODE 📖

This mode tells you where the animals live and also teaches colours.

In addition to these depending on which mode is selected you will hear sound effects, tunes, sung-songs and a variety of phrases. In each mode the lights will flash with the sounds.

To turn the unit OFF, slide the MODE SELECTOR SWITCH to the OFF (OFF) position.

2. ADD-ONS

Place the **torch**, **compass** or **walkie-talkie** into the recognition slot at the top of the zebra’s head to fun sounds, short tunes and phrases whilst learning about animals, directions and scenes. The lights will flash with the sounds.

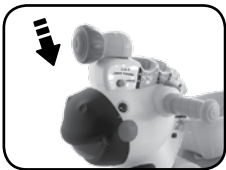

3. HORN BUTTON

Press the **horn button** on the left handle to hear fun horn sounds, a playful

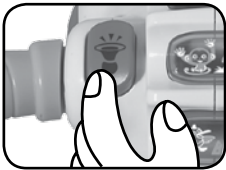

phrase, or a sung-song depending on the selected mode. The lights will flash with the sounds.

4. SMILE BUTTON

Press the **smile button** on the right handle to hear a variety of sounds or sung-songs depending on the selected mode. The lights will flash with the sounds.



5. LIGHT-UP BUTTONS

Press the **5 light-up buttons** to learn animals, animal sounds, scenes and colours depending on which mode is selected. The animal buttons feature a lion, kangaroo, monkey, hummingbird and hippo with their scene (savannah, outback, jungle, mountain and river). The lights will flash with the sounds.

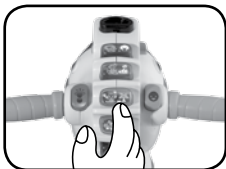

6. WALKER POSITION

Change the seat/handle to this position so that toddlers can practice their first steps. Recommended/estimated age for this position is 18+ months. Please push to play and place the bucket on the seat.



7. RIDE-ON POSITION

Change the position of the seat/handle to this position so that little ones can sit on the zebra and ride-around.



Recommended/estimated age for this position is 24+ months. Place the bucket on the neck to hold the play pieces.

8. SCOOTER POSITION

Change the position of the seat/handle to this position so that little ones can scoot around on the zebra. Recommended/estimated age for this position is 24-36 months. Place the bucket on the neck to hold the play pieces.



In all these positions when the zebra moves along a variety of sounds, phrases and music will play depending on which mode has been selected. The light-up buttons flash with the sounds. Ride around faster and the music speeds up.

9. AUTOMATIC SHUT DOWN

If there is no input to the unit after approximately 5 seconds, you will hear a question. After another 5 seconds if there is still no input, you will hear a fun sung-song or an encouraging phrase. After another 5 seconds if there is still no input, you will hear some fun sounds and an encouraging phrase. After another 5 seconds if there is still no input, you will hear the phrase “Bye-bye,” then the unit will automatically power-down.

MELODY LIST

1. Polly Wolly Doodle
2. Here We Go Round the Mulberry Bush
3. Pop! Goes the Weasel
4. Row, Row, Row Your Boat
5. Skip to My Lou
6. Alouette

SUNG-SONG LYRICS

SUNG-SONG 1

Roll along on the zebra,

He is your new friend,

Colours, animals and places the fun it never ends!

SUNG-SONG 2

Pushing, rolling, move along

Playing with my friends is fun!

CARE & MAINTENANCE

1. Keep the unit clean by wiping it with a slightly damp cloth.
2. Keep the unit out of direct sunlight and away from any direct heat source.
3. Remove the batteries when the unit is not in use for an extended period of time.
4. Do not drop the unit on hard surfaces and do not expose the unit to moisture or water.

TROUBLESHOOTING

If for some reason the program/activity stops working or malfunctions, please follow these steps:

1. Please turn the unit **OFF**.
2. Interrupt the power supply by removing the batteries.
3. Let the unit stand for a few minutes, then replace the batteries.
4. Turn the unit **ON**. The unit should now be ready to play again.
5. If the product still does not work, replace with an entire set of new batteries.

If the problem persists, please call our Consumer Services Department on 01235 546810 (from UK) or +44 1235 546810 (outside UK) and a service representative will be happy to help you.

IMPORTANT NOTE:

Creating and developing **VTech®** products is accompanied by a responsibility that we take very seriously. We make every effort to ensure the accuracy of the information, which forms the value of our products. However, errors sometimes can occur. It is important for you to know that we stand behind our products and encourage you to call our Consumer Services Department on 01235 546810 (from UK) or +44 1235 546810 (outside UK), with any problems and/or suggestions that you might have. A service representative will be happy to help you.



**CLASS 1
LED PRODUCT**



PRODUCT WARRANTY



Thank you for choosing this quality product from VTech. We hope it will bring many hours of entertainment, imaginative play and learning.

1. The product detailed above is covered by a one year warranty from the date of purchase, against any defects in materials or workmanship.
2. The product may be returned to the place of purchase. Alternatively the product can be returned to VTech Electronics Europe plc (see address below), with proof of purchase, without proof of purchase no replacement will be provided.
3. VTech Electronics Europe plc will examine the product and if it is found to be defective due to faulty materials or workmanship, will replace the product at their discretion.
4. If the product covered by this warranty is damaged due to misuse, modification or unauthorised repair, or because of faulty batteries, battery discharge or incorrect electrical connections, then this warranty becomes void.
5. This warranty is personal to the original purchaser and is not transferable.
6. Breakages to the LCD screen are not covered by the warranty.
7. Returns to VTech Electronics Europe plc should include a cheque or postal order for £1.50 towards the cost of return postage and packaging.
8. Products returned to VTech Electronics Europe plc, should be addressed as follows and packed carefully to avoid damage in transit (Please do not include batteries or adaptor).
Please include details of the fault together with your name and address.

VTech Electronics Europe plc, c/o Tablogix Limited, 200 Milton Park, Abingdon, Oxon OX14 4TA

THIS WARRANTY IS OFFERED AS AN EXTRA BENEFIT AND DOES NOT AFFECT CONSUMERS' STATUTORY RIGHTS.

This warranty is valid for the UK and Eire only. For products purchased outside the UK and Eire, please contact your local distributor or place of purchase.

Join the VTech club online at www.vtechuk.com

